

RGE.23
RGE.22

CITY OF HUMBOLDT

ZONING MAP

THIS IS THE ZONING DISTRICT MAP REFERRED TO IN
BYLAW NUMBER _____ ADOPTED BY THE

CITY OF HUMBOLDT

MAYOR _____

CITY CLERK _____

APPROVED ON THE _____ DAY OF _____, 2009.

DEPUTY MINISTER OF MUNICIPAL AFFAIRS



LEGEND

ZONING DISTRICTS

- R1** Residential, Low Density
- R2** Residential, Medium Density
- R3** Residential, Core, Mixed Use
- R4** Residential, Acreage
- R5** Residential, Mobile Homes
- C1** Commercial, Core
- C2** Commercial, Medium Density
- C3** Commercial, Commercial/Industrial Mixed Use
- M1** Industrial, Light
- M2** Industrial, Heavy
- CS** Community Service/Institutional
- UH** Urban Holding

- Railroad
- Provincial Highway
- City Limits

OVERLAY DISTRICTS

- ep** Environmental Protection

NOTE:

This map has been produced by Professional Community Planning Services Ltd. using information supplied by others. Geospatial data and topographic data (Copyright Her Majesty the Queen in Right of Canada) have been provided by Information Services Corporation of Saskatchewan, and/or Saskatchewan Dept. Of Highways for the production of this map under license to the municipality. Services and drawings have been provided by the City of Humboldt. It is the responsibility of the user to verify the accuracy of the information since changes in assessment, ownership and other information may have changed since the time of printing.

JOHN WOLFENBERG
Professional Community
Planning Services Ltd.

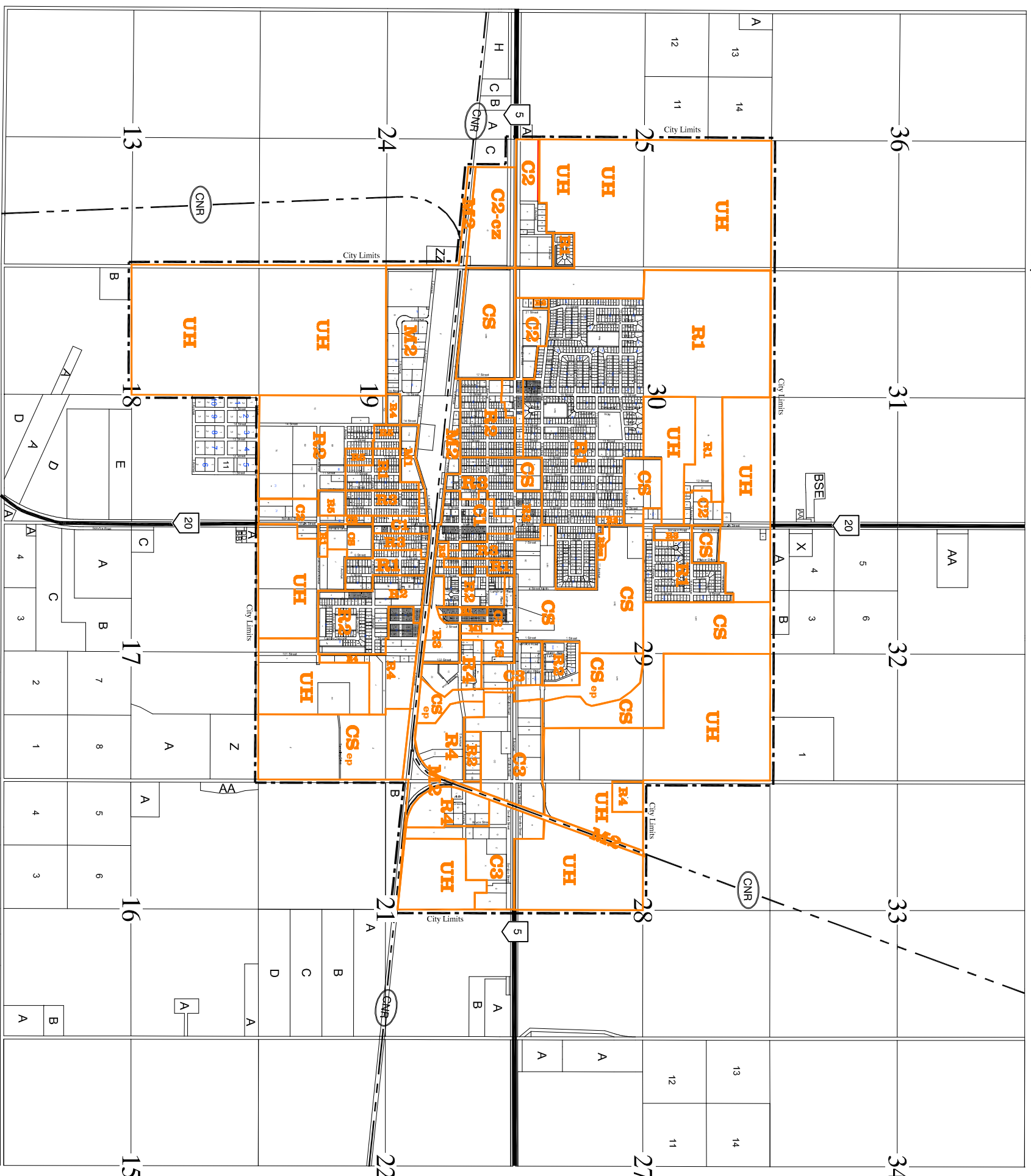
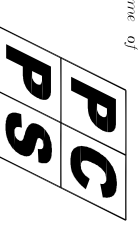

RGE.23
RGE.22

